



Hill Hall, Epping, CM16

BUTLER & STAG



Hill Hall is located in an exclusive private gated development of just twenty properties. An impressive Grade I Listed Elizabethan country residence together with Grade II listed mews houses.

With a grand entrance, Hill Hall development, is a characterful property set within manicured grounds of approximately twenty acres, which include tennis courts, Victorian ponds, rose garden, and twenty acres of parkland, all just three miles from the historical town Epping and central line for easy access into central London.



- Three Double Bedrooms
- Available Now
- Gated Development
- Private & Communal Gardens
- Off Street Parking
- Garage





Hill Hall, CM16

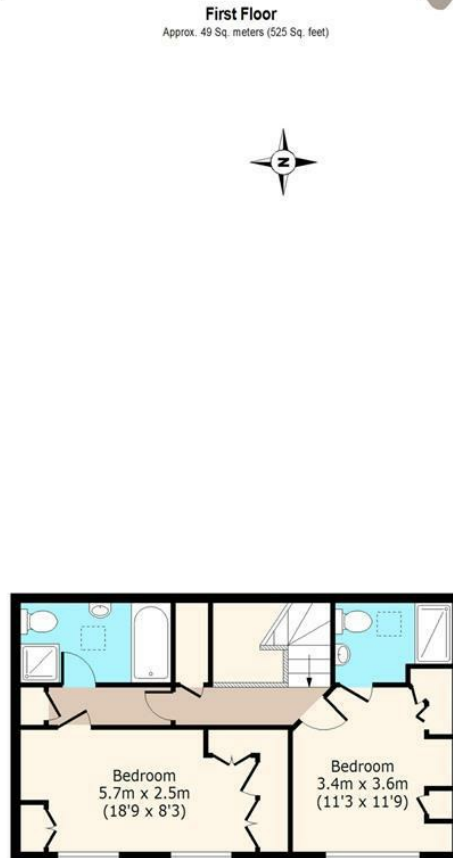

Total area: approx. 141 Sq. meters (1518 Sq. feet)
For illustration purposes only - not to scale
www.londonpropertyassessments.co.uk

BUTLER & STAG

☎ 01992 667666

🏠 4 Forest Drive, Theydon Bois, Essex, CM16 7EY

✉ theydon@butlerandstag.com

www.butlerandstag.uk

IMPORTANT NOTICE - These particulars have been prepared in good faith and they are not intended to constitute part of an offer or contract. We have not performed a structural survey on this property and the services, appliances and specific fittings have not been tested. All photographs, measurements, floor plans and distances referred to are given as a guide and should not be relied upon.